

# LC120-12P

## High-efficiency PV Module

### Features

- high energy yields ensured by high conversion efficiency
- sturdy, clear-anodized aluminum frame with pre-drilled holes for quick installation
- advanced EVA encapsulation with triple-layer backsheet, meets the most stringent safety requirements for high-voltage operation
- pre-wired junction box equipped with connectors "plug'n'play"
- reliable bypass diodes to prevent overheating (hot spot effect) and to minimise power loss by shading
- manufactured in ISO 9001:2000-certified factory

### Applications

- water pumping
- water purification systems
- remote village lighting
- solar home systems
- street and camp lights
- traffic signals
- medical facilities in remote areas
- microwave/radio repeater stations
- battery charging
- etc.



photo may differ from actual product

### Warranty

- Warranty: 2 years
- Performance guarantee:  
up to 10 years (90% power output)  
up to 20 years (80% power output)

Details according to warranty issued by LORENTZ

### Standards

LC120-12P is certified according to IEC 61215 and 61730 by TÜV Rheinland and meets the requirements for CE.



- Qualified, IEC 61215
- Safety tested, IEC 61730
- Periodic Inspection



### Specifications

#### Electrical Data

Peak power	P <sub>max</sub>	[Wp]	120
Tolerance		[%]	+3/-3
Max. power current	I <sub>mp</sub>	[A]	7.0
Max. power voltage	V <sub>mp</sub>	[V]	17.1
Short circuit current	I <sub>sc</sub>	[A]	7.7
Open circuit voltage	V <sub>oc</sub>	[V]	21.8
Temperature co-efficient for P <sub>max</sub>		[%/°C]	-0.50
Temperature co-efficient for V <sub>oc</sub>		[%/°C]	-0.35
Temperature co-efficient for I <sub>sc</sub>		[%/°C]	0.09
Max. system voltage		[V]	1,000

All technical data at standard test condition:  
AM = 1.5, E = 1,000W/m<sup>2</sup>, cell temperature: 25 °C

#### Cells

Number of cells in series	36
Number of cells in parallel	1
Cell technology	polycrystalline
Cell shape	rectangular

To find out more visit [www.lorentz.de](http://www.lorentz.de)

BERNT LORENTZ GmbH & Co. KG

Kroegerskoppel 7, 24558 Henstedt-Ulzburg, Germany, Tel. +49 (0) 4193 7548-0

Errors excepted and possible alterations without prior notice. Pictures may differ from actual products depending on local market requirements and regulations. A pump system consists of a controller, motor and pump end. Multiple pumps/pump ends are shown to represent the wide range of pumps (over 70) that LORENTZ has.

**Sun. Water. Life.**

## Electrical Performance

### Electrical Performance

for different temperatures, at AM=1.5, E=1,000W/m<sup>2</sup>

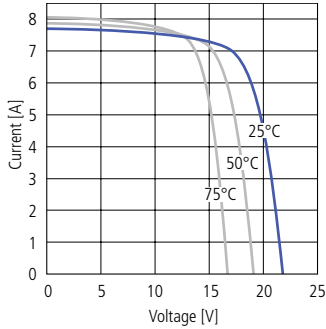

### Electrical Performance

for different irradiation, at 25°C

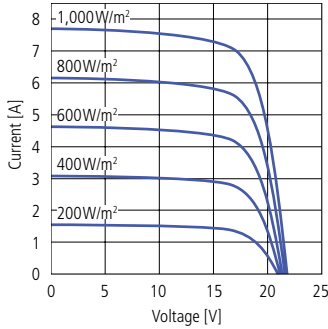

### Temperature Dependence

of I<sub>sc</sub>, V<sub>oc</sub> and P<sub>max</sub>

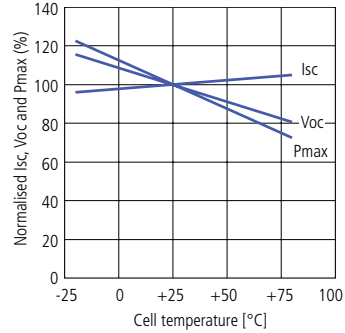

### Irradiation Dependence

of I<sub>sc</sub>, V<sub>oc</sub> and P<sub>max</sub> at 25°C

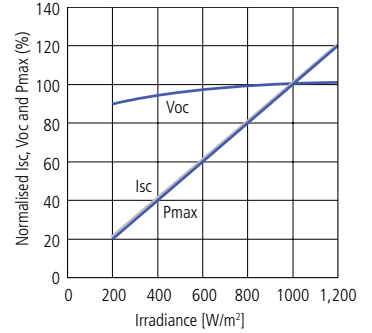

## Physical Specifications mm [in]

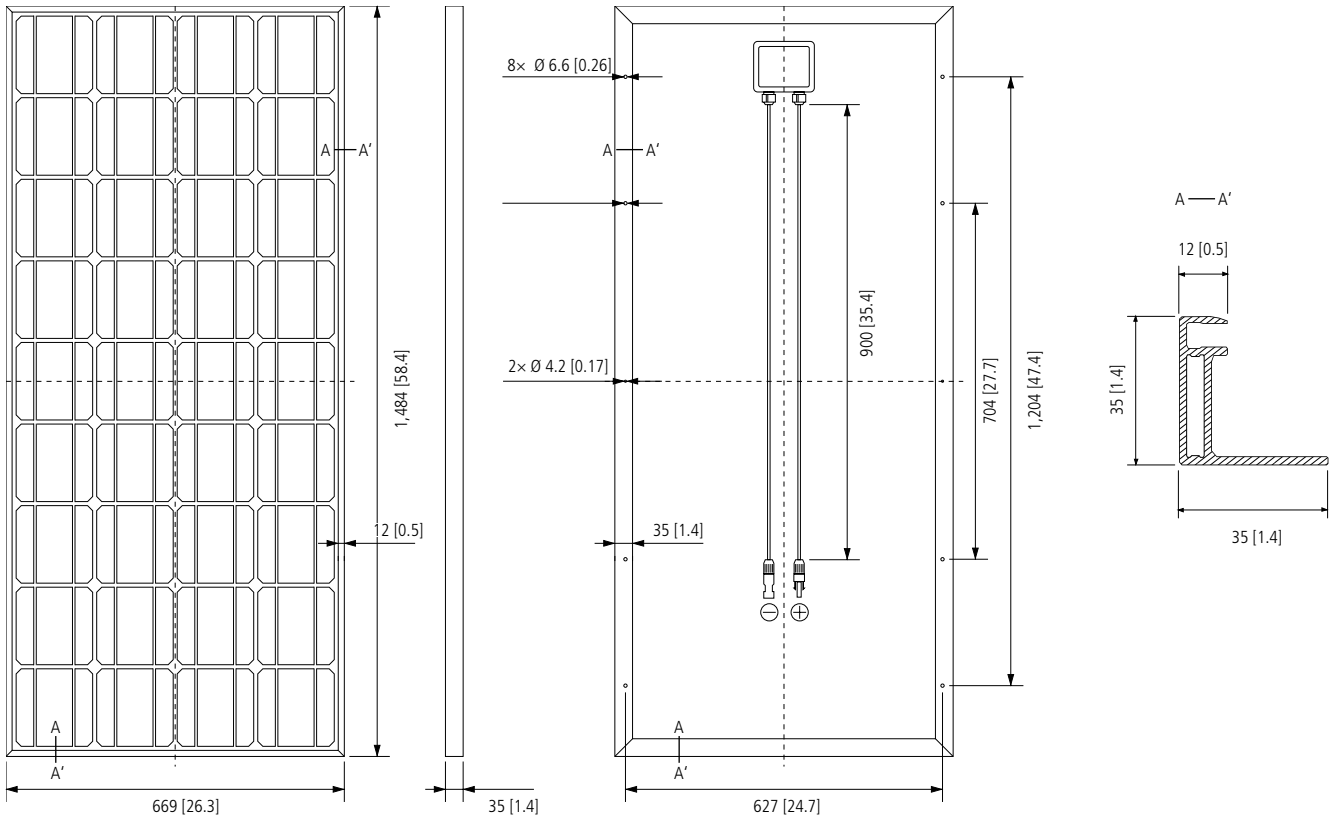

Weight	[kg]	13.5
Dimension	[mm]	669 × 1,484 × 35
Strength	[N/m <sup>2</sup> ]	2,400
Cable		approx. 900 mm / 35 in, 4 mm <sup>2</sup> / AWG 12
Connectors		MC4 PV-KBT4/6II-UR / PV-KST4/6II-UR

To find out more visit [www.lorentz.de](http://www.lorentz.de)

BERNT LORENTZ GmbH & Co. KG

Kroegerskoppel 7, 24558 Henstedt-Ulzburg, Germany, Tel. +49 (0) 4193 7548-0

Errors excepted and possible alterations without prior notice. Pictures may differ from actual products depending on local market requirements and regulations. A pump system consists of a controller, motor and pump end. Multiple pumps/pump ends are shown to represent the wide range of pumps (over 70) that LORENTZ has.

**Sun. Water. Life.**